



Tecumseh



A Legend is Reborn.

Introducing the all-New AE² Next Generation Compressor

REDUCED ENERGY CONSUMPTION

- Most efficient compressor of its size on the market
- Approaching 11 EER with R290 applications

WIDER CAPACITY IN A SMALLER ENVELOPE

- Reduced size envelope covers capacities normally served by larger compressors

ENVIRONMENTALLY FRIENDLY

- Designed for optimal performance with “Green” hydrocarbon refrigerants R290 and R600a
- Supports R134a and R404A

PROVEN RELIABILITY

- Leverages robust design attributes developed from 50-years of AE commercial refrigeration experience

WORLDWIDE PRODUCT OFFERING

- Available across the globe, with flexibility to meet regional needs and agency approvals

SERVICE AND SUPPORT

- Backed by Tecumseh's network of knowledgeable application engineers, test labs & support personnel

SPECIFICATIONS

Product: AE²

Evaporating Ranges: High Back: -10°F to +50°F (-25°C to +15°C)
Low Back: -40°F to +10°F (-40°C to -10°C)

Refrigerant: R134a, R404A, R290, R600a

Capacity: 1/6 hp through 1/2 hp

Connections: Copper braze suction and discharge connections

Features

Oil: Polyolester (POE)

Footprint: Industry Standard 4.5" x 7.0"

Motor Type: Capacitor Start Run (CSR)
Capacitor Start Induction Run (CSIR)

Voltages: 115/60/1 230/50/1
115-127/60/1 220/50/1
220/60/1 220-240/50/1

Agency Approval Listing: UL®, CE, other approvals available on request

COMPRESSOR MODEL NUMBER

AE 4 440 Y - XA 3 C

Family

Application

High and Low

Capacity

First number is total digits

Remainder is Capacity in Btuh at 60 Hz

This example: 4000 Btuh Capacity

Refrigerant

U = R290 Y = R134a Z = R404A

Release Variant

Run Capacitor

Voltage

AA 115V/60/1
DS 115-127V/60/1
ES 220V/60/1
FS 220V/50/1
FZ 220-240V/50/1
GH 230V/50/1
GS 220V/50/60/1

DIMENSIONS

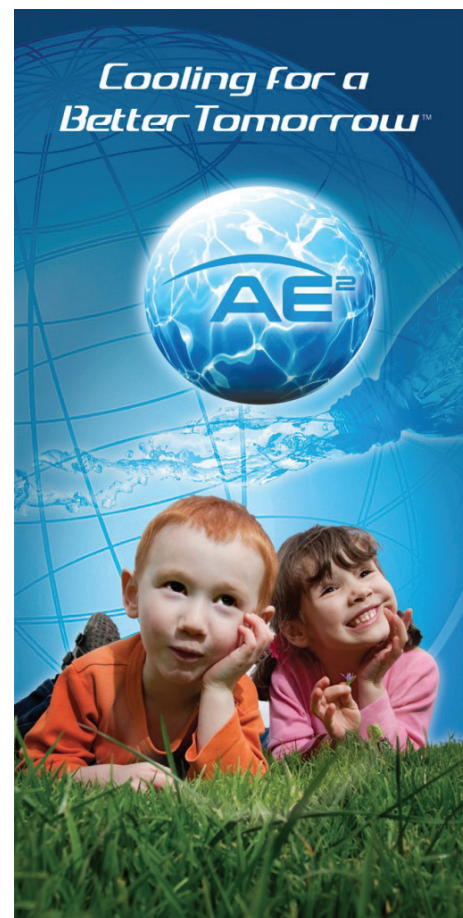
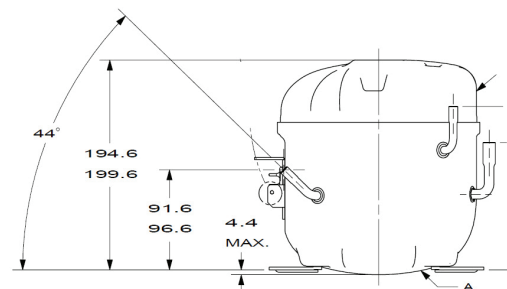
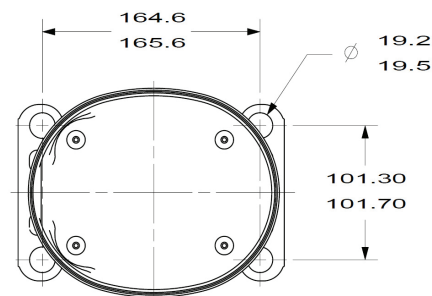

OPERATING ENVELOPE

Refrigerant	Capacity in Btuh (60 Hz, Single Phase)						
	800	1,000	1,500	2,500	5,000	6,000	7,000

High Back Pressure							
R134a							
R290							
R404A							

Low Back Pressure							
R134a							
R290							
R404A							
R600a							